

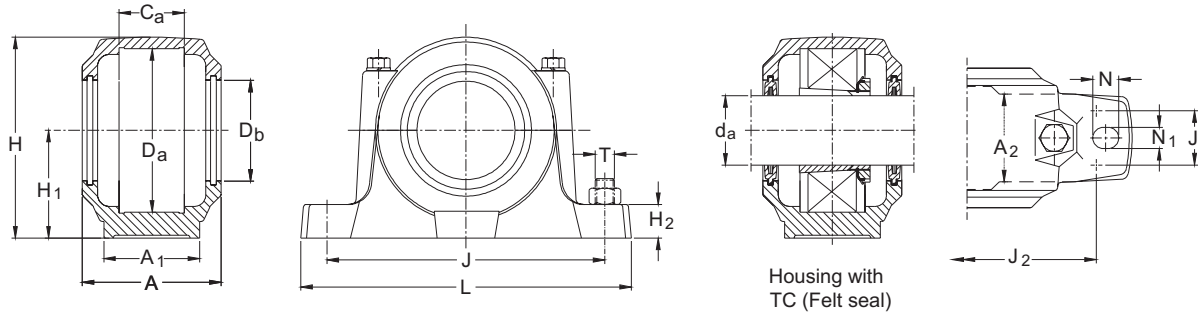

SNA 500 & 600 Series Bearing Housing for Bearings with ADAPTER SLEEVE TABLE - 11
shaft dia 25 to 140 mm



Material	C.I. FG 200 - IS 210, 1993
Mfg. Standard	IS 14347 - 1996 ISO 113 - 1994
Seal	TA, TC or TG
Lubrication Type	Grease or Oil Horizontal Split Type
Application	Relatively higher load application like paper, mining construction and conveyor. Better sealing arrangement permits dusty and temperature surrounding.
Options Available	a) 4 Foundation Bolt Hole Base b) Labyrinth seal c) End cover for closed end type d) Material : C.S. Gr 280/520, IS 1030 & S.G. Iron e) Solid base for heavy load application

Shaft dia.	Housing Dimensions														Approx Weight	Designations			Bearing with adapter sleeve Designation		Locating ring(s)		Grease Initial fill (recommended)	Housing without seals Designation
	da	A	A ₁	A ₂	Ca	Da	Db	H	H ₁	H ₂	J	L	N	N ₁		T	TA	With seal type TC	TG	Bearing	Adapter Sleeve	size		
mm															kg	-	-	-	-	-	-	-	-	
20	67	46	42	25	52	31,5	71	40	19	130	165	20	13	10	1,40	SNA 505 TA	SNA 505 TC	SNA 505 TG	1205 K 2205 K	H 205 H 305	FRB 5/52 P FRB 7/52 P	2 1	0,025	SNA 505
	77	52	45	32	62	36,5	87	50	22	150	185	22	13	10	1,95	SNA 605 TA	SNA 605 TC	SNA 605 TG	1305 K	H 305	FRB 7,5/62 P	2	0,040	SNA 506-605
25	77	52	45	32	62	36,5	87	50	22	150	185	22	13	10	1,95	SNA 506 TA	SNA 506 TC	SNA 506 TG	1206 K 2206 K	H 206 H 306	FRB 8/62 P FRB 6/62 P	2 2	0,040	SNA 506-605
	82	52	45	34	72	46,5	92	50	22	150	185	20	13	10	2,00	SNA 606 TA	SNA 606 TC	SNA 606 TG	1306 K 2306 K	H 306 H 2306	FRB 7,5/72 P FRB 7/72 P	2 1	0,050	SNA 507-606
30	82	52	45	34	72	46,5	92	50	22	150	185	20	13	10	2,00	SNA 507 TA	SNA 507 TC	SNA 507 TG	1207 K 2207 K 22207 CCK	H 207 H 307 H 307	FRB 8,5/72 P FRB 5,5/72 P FRB 5,5/72 P	2 2 2	0,050	SNA 507-606
	85	60	50	39	80	51,5	106	60	25	170	205	20	15	12	2,65	SNA 607 TA	SNA 607 TC	SNA 607 TG	1307 K 2307 K	H 307 H 2307	FRB 9/80 P FRB 8/80 P	2 1	0,065	SNA 508-607
35	85	60	50	39	80	51,5	106	60	25	170	205	20	15	12	2,65	SNA 508 TA	SNA 508 TC	SNA 508 TG	1208 K 2208 K 22208 CCK	H 208 H 308 H 308	FRB 10,5/80 P FRB 8/80 P FRB 8/80 P	2 2 2	0,065	SNA 508-607
	90	60	50	41	90	62	112	60	25	170	205	20	15	12	3,00	SNA 608 TA	SNA 608 TC	SNA 608 TG	1308 K 2308 K 21308 CCK 22308 CCK	H 308 H 2308 H 308 H 2308	FRB 9/90 P FRB 8/90 P FRB 9/90 P FRB 8/90 P	2 1 2 1	0,10	SNA 510-608

TABLE - 11

Shaft dia.	Housing Dimensions														Approx Weight	Designations			Bearing with adapter sleeve Designation		Locating ring(s)		Grease Initial fill (recommended)	Housing without seals Designation			
	d _a	A	A ₁	A ₂	C _a	D _a	D _b	H	H ₁	H ₂	J	L	N	N ₁		T	TA	With seal type TC	TG	Bearing	Adapter Sleeve	size			Qty.	kg	-
mm															kg	-	-	-	-	-	-	-	-	-	-	-	-
40	85	60	50	30	85	56,5	109	60	25	170	205	20	15	12	2,80	SNA 509 TA	SNA 509 TC	SNA 509 TG	1209 K	H 209	FRB 5.5/85 P	2	0,080	SNA 509			
																			2209 K	H 309	FRB 7/85 P	1					
																			22209 CCK	H 309	FRB 7/85 P	1					
95	70	58	44	100	67	127	70	28	210	255	23	18	16	4,35	SNA 609 TA	SNA 609 TC	SNA 609 TG	1309 K	H 309	FRB 9.5/100 P	2	0,13	SNA 51 1-609				
																		2309 K	H 2309	FRB 8/100 P	1						
																		21309 CCK	H 309	FRB 9.5/100 P	2						
																		22309 CCK	H 2309	FRB 8/100 P	1						
45	90	60	50	41	90	62	112	60	25	170	205	20	15	12	3,00	SNA 510 TA	SNA 510 TC	SNA 510 TG	1210 K	H 210	FRB 10.5/90 P	2	0,10	SNA 510-608			
																			2210 K	H 310	FRB 9/90 P	2					
																			22210 CCK	H 310	FRB 9/90 P	2					
105	70	60	48	110	72	133	70	30	210	255	23	18	16	4,90	SNA 610 TA	SNA 610 TC	SNA 610 TG	1310 K	H 310	FRB 10.5/110 P	2	0,15	SNA 512-610				
																		2310 K	H 2310	FRB 8/110 P	1						
																		21310 CCK	H 310	FRB 10.5/110 P	2						
																		22310 CCK	H 2310	FRB 8/110 P	1						
50	95	70	58	44	100	67	127	70	28	210	255	23	18	16	4,35	SNA 511 TA	SNA 511 TC	SNA 511 TG	1211 K	H 211	FRB 11.5/100 P	2	0,13	SNA 51 1-609			
																			2211 K	H 311	FRB 9.5/100 P	2					
																			22211 CCK	H 311	FRB 9.5/100 P	2					
110	80	65	51	120	77	148	80	30	230	275	24	18	16	5,80	SNA 611 TA	SNA 611 TC	SNA 611 TG	1311 K	H 311	FRB 11/120 P	2	0,19	SNA 513-611				
																		2311 K	H 2311	FRB 8/120 P	1						
																		21311 CCK	H 311	FRB 11/120 P	2						
																		22311 CCK	H 2311	FRB 8/120 P	1						
55	105	70	60	48	110	72	133	70	30	210	255	23	18	16	4,90	SNA 512 TA	SNA 512 TC	SNA 512 TG	1212 K	H 212	FRB 13/110 P	2	0,15	SNA 512-610			
																			2212 K	H 312	FRB 10/110 P	2					
																			22212 CCK	H 312	FRB 10/110 P	2					
115	80	65	56	130	87	154	80	30	230	280	26	18	16	6,50	SNA 612 TA	SNA 612 TC	SNA 612 TG	1312 K	H 312	FRB 12.5/130 P	2	0,24	SNA 515-612				
																		2312 K	H 2312	FRB 10/130 P	1						
																		21312 CCK	H 312	FRB 12.5/130 P	2						
																		22312 CCK	H 2312	FRB 10/130 P	1						



SNA 500 & 600 Series Bearing Housing for Bearings with ADAPTER SLEEVE TABLE - 11
shaft dia 25 to 140 mm

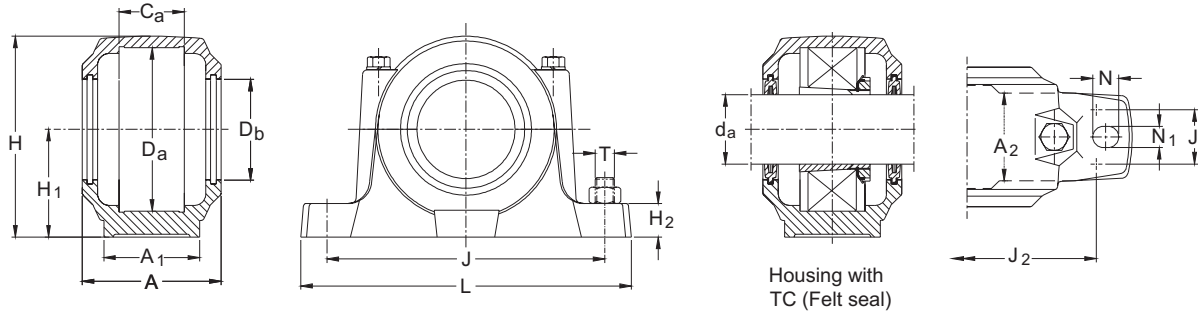

Material	C.I. FG 200 - IS 210, 1993
Mfg.	IS 14347 - 1996
Standard	ISO 113 - 1994
Seal	TA, TC or TG
Lubrication	Grease or Oil
Type	Horizontal Split Type
Application	Relatively higher load application like paper, mining construction and conveyor. Better sealing arrangement permits dusty and temperature surrounding.
Options Available	a) 4 Foundation Bolt Hole Base b) Labyrinth seal c) End cover for closed end type d) Material : C.S. Gr 280/520, IS 1030 & S.G. Iron e) Solid base for heavy load application

Shaft dia.	Housing Dimensions														Approx Weight	Designations			Bearing with adapter sleeve Designation		Locating ring(s)		Grease Initial fill (recommended)	Housing without seals Designation
	da	A	A ₁	A ₂	Ca	Da	Db	H	H ₁	H ₂	J	L	N	N ₁		T	TA	With seal type TC	TG	Bearing	Adapter Sleeve	Size		
mm															kg	-	-	-	-	-	-	-	-	
60	110	80	65	51	120	77	148	80	30	230	275	24	18	16	5,80	SNA 513 TA	SNA 513 TC	SNA 513 TG	1213 K	H 213	FRB 14/120 P	2	0,19	SNA 513-611
																			2213 K	H 313	FRB 10/120 P	2		
																			2213 CCK	H 313	FRB 10/120 P	2		
120	90	75	58	140	92,5	175	95	32	260	315	29	22	20	9,00	SNA 613 TA	SNA 613 TC	SNA 613 TG	1313 K	H 313	FRB 12,5/140 P	2	0,28	SNA 516-613	
																		2313 K	H 2313	FRB 10/140 P	1			
																		21313 CCK	H 313	FRB 12,5/140 P	2			
																		22313 CCK	H 2313	FRB 10/140 P	1			
65	115	80	65	56	130	87	154	80	30	230	280	26	18	16	6,50	SNA 515 TA	SNA 515 TC	SNA 515 TG	1215 K	H 215	FRB 15,5/130 P	2	0,24	SNA 515-612
																			2215 K	H 315	FRB 12,5/130 P	2		
																			22215 CCK	H 315	FRB 12,5/130 P	2		
140	100	85	65	160	102,5	192	100	35	290	345	27	22	20	12,60	SNA 615 TA	SNA 615 TC	SNA 615 TG	1315 K	H 315	FRB 14/160 P	2	0,40	SNA 518-615	
																		2315 K	H 2315	FRB 10/160 P	1			
																		21315 CCK	H 315	FRB 14/160 P	2			
																		22315 CCK	H 2315	FRB 10/160 P	1			
70	120	90	75	58	140	92,5	175	95	32	260	315	29	22	20	9,00	SNA 516 TA	SNA 516 TC	SNA 516 TG	1216 K	H 216	FRB 16/140 P	2	0,28	SNA 516-613
																			2216 K	H 316	FRB 12,5/140 P	2		
																			22216 CCK	H 316	FRB 12,5/140 P	2		
145	100	85	68	170	131	209	112	35	290	345	27	22	20	14,0	SNA 616 TA	SNA 616 TC	SNA 616 TG	1316 K	H 316	FRB 14,5/170 P	2	0,40	SNA 519-616	
																		2316 K	H 2316	FRB 10/170 P	1			
																		21316 CCK	H 316	FRB 14,5/170 P	2			
																		22316 CCK	H 2316	FRB 10/170 P	1			
75	125	90	75	61	150	97,5	181	95	32	260	320	30	22	20	10,0	SNA 517 TA	SNA 517 TC	SNA 517 TG	1217 K	H 217	FRB 16,5/150 P	2	0,32	SNA 517
																			2217 K	H 317	FRB 12,5/150 P	2		
																			22217CCK	H 317	FRB 12,5/150 P	2		

TABLE - 11

Shaft dia.	Housing Dimensions														Approx Weight	Designations			Bearing with adapter sleeve Designation		Locating ring(s)		Grease Initial fill (recommended)	Housing without seals Designation	
	d _a	A	A ₁	A ₂	C _a	D _a	D _b	H	H ₁	H ₂	J	L	N	N ₁		T	TA	With seal type TC	TG	Bearing	Adapter Sleeve	Size			Qty.
mm															kg	-				-	Size		Qty.	kg	-
	160	110	95	70	180	137,5	215	112	40	320	380	32	26	24	17,3	SNA 617 TA	SNA 617 TC	SNA 617 TG	1317 K 2317 K 21317 CCK 22317 CCK/W33	H 317 H 2317 H 317 H 2317	FRB 14,5/180 P FRB 10/180 P FRB 14,5/180 P FRB 10/180 P	2 1 2 1	0,60	SNA 520-617	
80	140	100	85	65	160	102,5	192	100	35	290	345	27	22	20	12,6	SNA 518 TA	SNA 518 TC	SNA 518 TG	1218 K 2218 K 22218 CCK 23218 CCK	H 218 H 318 H 318 H 2318	FRB 17,5/160 P FRB 12,5/160 P FRB 12,5/160 P FRB 12,5/160 P	2 2 2 1	0,40	SNA 518-615	
85	145	100	85	68	170	131	209	112	35	290	345	27	22	20	14,0	SNA 519 TA	SNA 519 TC	SNA 519 TG	1219 K 2219 K 22219 CCK	H 219 H 319 H 319	FRB 18/170 P FRB 12,5/170 P FRB 12,5/170 P	2 2 2	0,50	SNA 519-616	
	175	120	100	80	200	147,5	239	125	45	350	410	32	26	24	21,0	SNA 619 TA	SNA 619 TC	SNA 619 TG	22319 CCK/W33	H 2319	FRB 13/200 P	1	0,85	SNA 522-619	
90	160	110	95	70	180	137,5	215	112	40	320	380	32	26	24	17,3	SNA 520 TA	SNA 520 TC	SNA 520 TG	1220 K 2220 K 22220 CCK/W33 23220 CCK/W33	H 220 H 320 H 320 H 2320	FRB 18/180 P FRB 12/180 P FRB 12/180 P FRB 9,7/180 P	2 2 2 1	0,60	SNA 520-617	
	185	120	100	86	215	157,5	271	140	45	350	410	32	26	24	25,0	SNA 620 TA	SNA 620 TC	SNA 620 TG	22320 CCK/W33	H 2320	FRB 13/215 P	1	1,00	SNA 524-620	
100	175	120	100	80	200	147,5	239	125	45	350	410	32	26	24	21,0	SNA 522 TA	SNA 522 TC	SNA 522 TG	1222 K 2222 K 22222 CCK/W33 23222 CCK/W33	H 222 H 322 H 322 H 2322	FRB 21/200 P FRB 13,5/200 P FRB 13,5/200 P FRB 10,2/200 P	2 2 2 1	0,85	SNA 522-619	
110	185	120	100	86	215	157,5	271	140	45	350	410	32	26	24	25,0	SNA 524 TA	SNA 524 TC	SNA 524 TG	22224 CCK/W33 23224 CCK/W33	H 3124 H 2324	FRB 14/215 P FRB 10/215 P	2 1	1,00	SNA 524-620	
115	190	130	110	90	230	167,5	290	150	50	380	445	35	28	24	33,0	SNA 526 TA	SNA 526 TC	SNA 526 TG	22226 CCK/W33 23226 CCK/W33	H 3126 H 2326	FRB 15/230 P FRB 10/230 P	2 1	1,00	SNA 526	
125	205	150	130	98	250	177,5	302	150	50	420	500	42	35	30	43,0	SNA 528 TA	SNA 528 TC	SNA 528 TG	22228 CCK/W33 23228 CCK/W33	H 3128 H 2328	FRB 15/250 P FRB 10/250 P	2 1	1,20	SNA 528	
135	220	160	140	106	270	192,5	323	160	60	450	530	42	35	30	51,0	SNA 530 TA	SNA 530 TC	SNA 530 TG	22230 CCK/W33 23230 CCK/W33	H 3130 H 2330	FRB 16,5/270 P FRB 10/270 P	2 1	1,50	SNA 530	
140	235	160	140	114	290	202,5	344	170	60	470	550	42	35	30	57,5	SNA 532 TA	SNA 532 TC	SNA 532 TG	22232 CCK/W33 23232 CCK/W33	H 3132 H 2332	FRB 17/290 P FRB 10/290 P	2 1	1,90	SNA 532	

- Note:**
1. Housing is supplied with 1/8" BSP grease nipple fitted on top.
 2. Housing is supplied as non-located type. For locating type order suitable locating ring ('FRB') separately.
 3. Refer Table III and V for selecting alternative material and seal in case of higher load conditions.
 4. Our SN, SNA & SNH type housings are designed inter-changeable for same bearing size and mounting dimensions.
 5. For higher load application solid base housings are available on request.
 6. Lifting Eye bolts are provided on housings from SNA 524 & SNA 620 onwards.